



Installation Instructions

For Part Numbers:

200-298 720-473 Airaid Oiled Media Filter

201-298 721-473 SynthaMax Dry Media Filter - Red

2015-16 Chevrolet Colorado / GMC Canyon
3.6L V6

2016-17 Chevrolet Colorado / GMC Canyon
2.8L Duramax

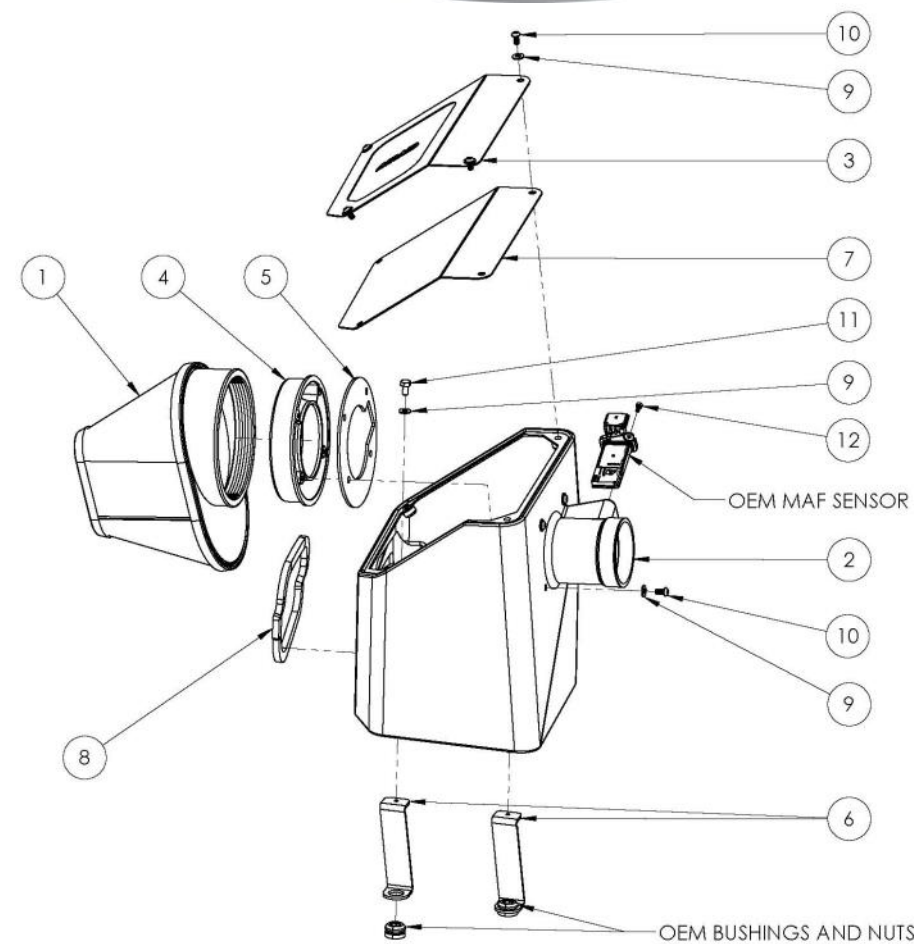

INTAKE SYSTEMS FOR VEHICLES LISTED ARE 50 STATE LEGAL. SEE AIRAID.COM FOR CARB STATUS ON EACH PART FOR A SPECIFIC VEHICLE.

Component Identification

1. AIR720/721-473	Airaid Premium Filter	1
2. AIR-KIT298CAB	Airaid Airbox	1
3. AIR-KIT298LID	Airbox Lid	1
4. 08785A	Filter Adapter	1
5. AIR-KIT298MAFG	Filter Adapter Gasket	1
6. AIR-KIT298B	Airbox Bracket	2
7. AIR-KIT298LIDGSKT	Lid Gasket	1
8. AIR-KIT298G	Airbox Seal	1
9. AIR-KIT09FWZ019	Flat Washer	10
10. 07794	6mm Button Head Screw	8
11. AIR-KIT08317	Hex Bolt	2
12. 07733	4mm Socket Head Screw	2
13. AIR-KIT110T	Zip Tie	1

Full color instructions can be viewed on our web site at Airaid.com. Use the **Product Search** function to find your part number, and click **View Details**. If you need any assistance please call 1-800-858-3333 to speak with a representative in our Customer Service Center before returning the product.



1. Disconnect the negative battery terminal.

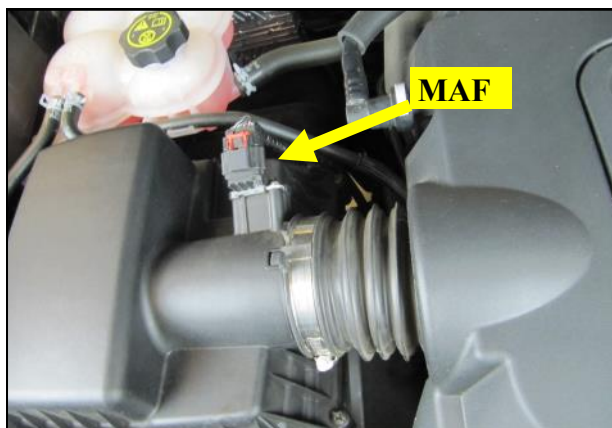

2. Disconnect the Mass Air Flow sensor, or MAF and un anchor the wiring harness from the air box lid.



3. Loosen the intake clamp and slide the tube off of the air box lid as shown. Using a screwdriver, remove the air box lid and air filter.

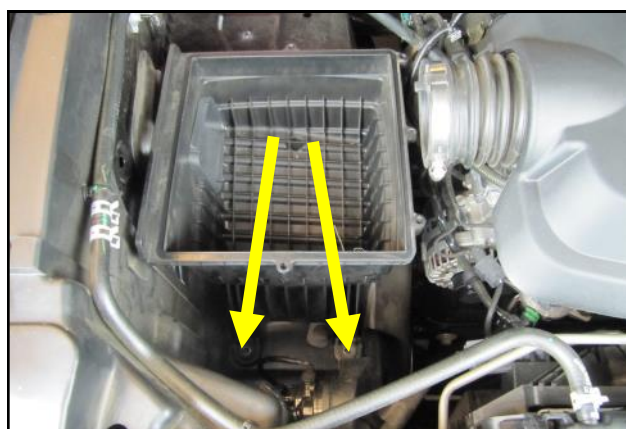

4. Remove the two 6mm flange nuts at the bottom of the air box and set them aside. These will be reused. Unseat the rear of the air box from its mounting grommet and remove it from the vehicle.



5. Prepare the Filter Adapter for installation by mating the Gasket to it. **Note:** The Filter Adapter and related parts have an asymmetrical bolt hole pattern.

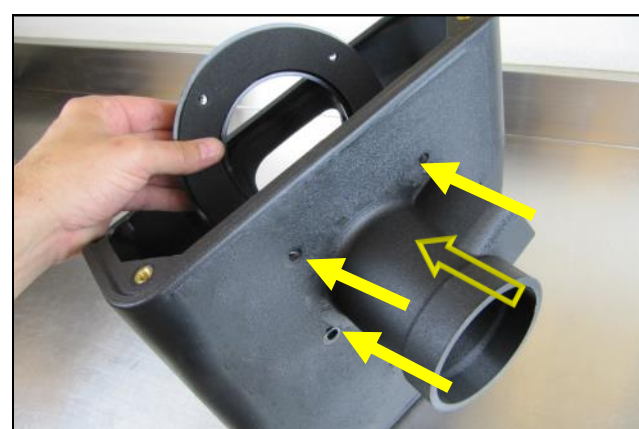

6. Mount the Filter Adapter and Gasket inside the Airaid Performance Air Box using 4 Button Head Screws and Flat Washers.

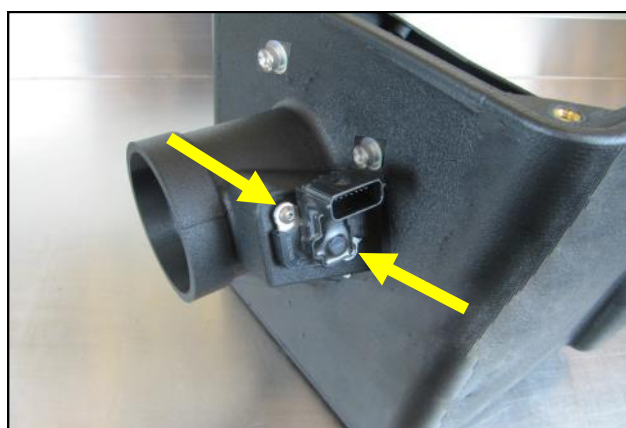

7. Transfer the Mass Air Flow sensor into the Airaid Air Box and secure it using the 4mm Socket Head Screws. **Do Not Use The Factory Hardware.**



8. Transfer OEM air box bushings and anti-crush sleeves into the Airaid Air Box Brackets as shown.

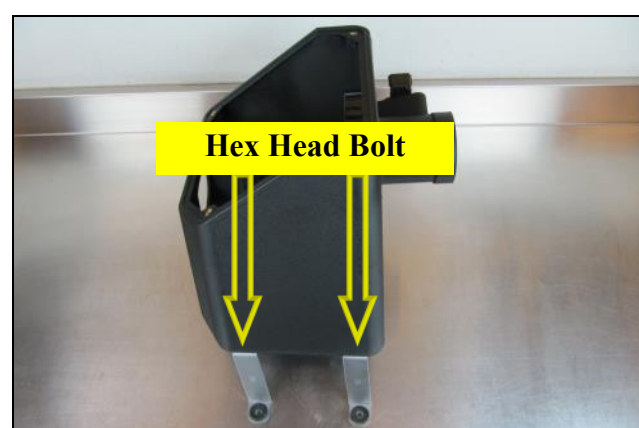

9. Mount the Air Box Brackets as shown, using a single Hex Head Bolt and Flat washer for each one. The Brackets are intended to be installed on the bottom of the Box by the bolts from inside the Box. Do not make the Bolts final tight at this time.



10. Prepare the Air Box for the weather Seal by cleaning the outer edge with a prep-sol or equivalent. Apply the self adhesive, Foam Weather Seal onto the Air box inlet as shown.

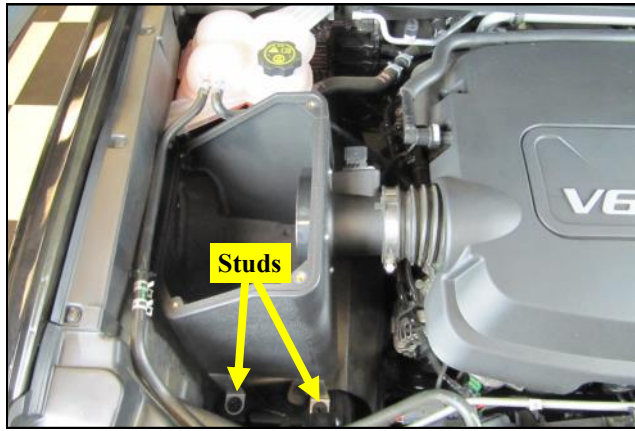

11. Carefully lower the Air Box assembly down into the inner fender area while guiding the Brackets onto the threaded studs. Connect the intake tube to the Airaid Air Box and tighten the clamp.

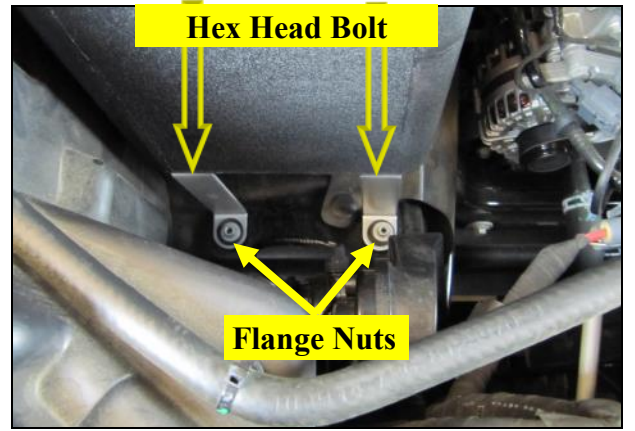

12. Realign Brackets if necessary and make the Hex Heads inside the Box final tight. Secure the Air Box assembly using the flange nuts removed in step 4.

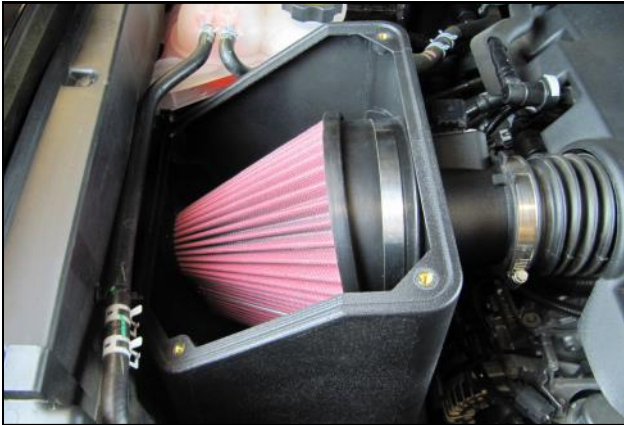

13. Install the Airaid Premium Filter onto the Adapter inside the Air Box and tighten the clamp.

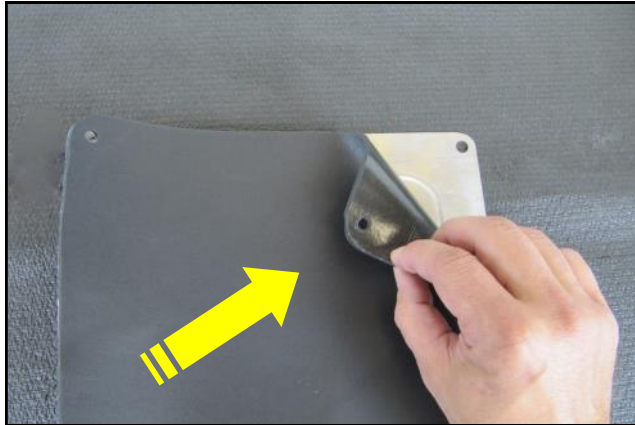

14. Remove the protective film from the top of the Air Box Lid. Prepare the underside for the Lid Gasket by cleaning it using a prep-sol or equivalent. Carefully apply the self adhesive Gasket onto the Lid as shown.

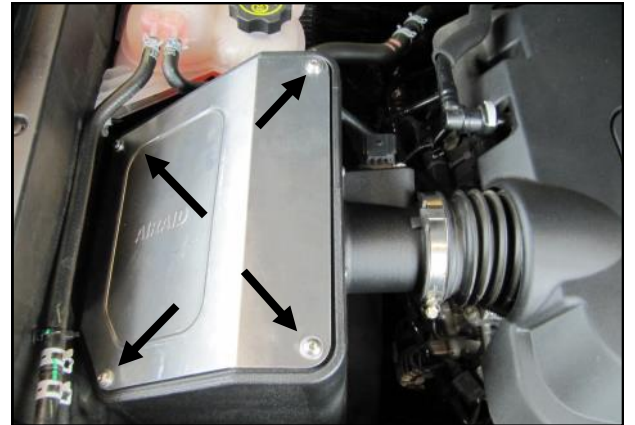

15. Mount the Lid onto the Air Box using the remaining Button Head Bolts and Flat washers.

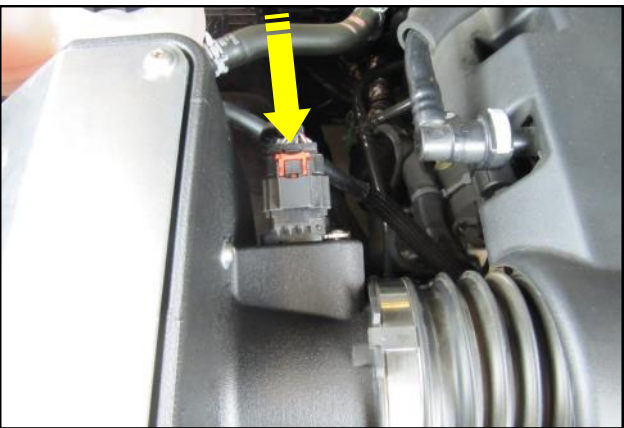

16. Reconnect the Mass Air Flow sensor.

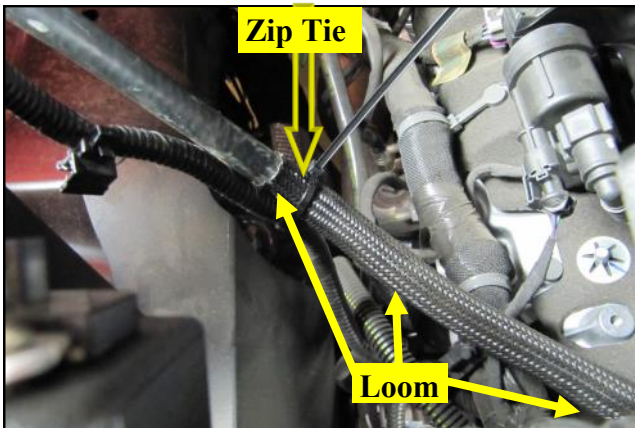

17. Using the supplied Zip Tie, secure MAF harness to the coolant line as shown and cut the excess. **Note:** The zip tie is not to have direct contact with the coolant hose itself, but rather wrap around the anti-abrasion loom.



18. **Double check your work!** Make sure there is no foreign material in the intake path. Make sure all clamps, hoses, bolts, and screws are tight. Double check the hood clearance! Reconnect the negative battery cable!



19. On Duramax Powered vehicles, maximum power is achieved by removing the airbox duct in the inner fender.

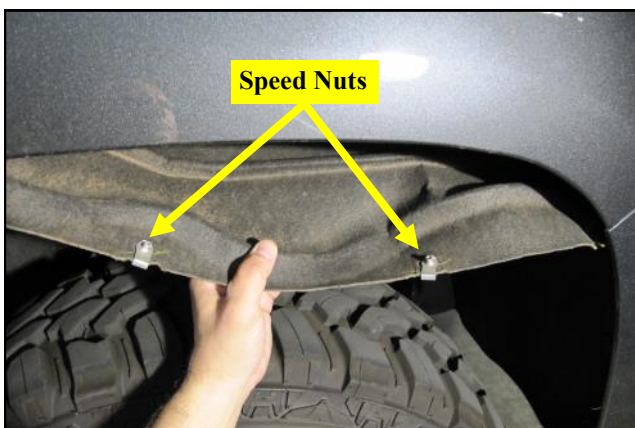

20. Inside the passenger side wheel well, remove the two center screws in the fender liner. Slide back the liner and pull it down. Take caution no to loose the speed nuts.

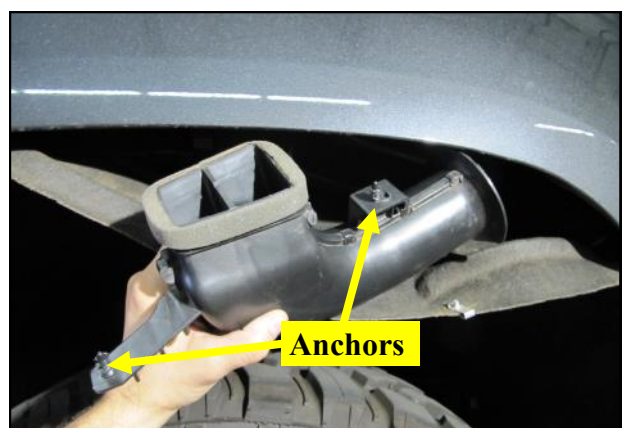

21. Gently pry out the two plastic anchors securing the air duct and remove it. Reinstall the fender liner.

Thank you for purchasing the Airaid Intake System. Contact Airaid @ (800) 498-6951 8:00 AM - 5:00 PM MST weekdays for questions regarding fit or instructions that are not clear to you. Your Airaid Intake System was carefully inspected and packaged. Check that no parts are missing, or were damaged during shipping. If any parts are missing, contact Airaid. The air filter element is protected from direct exposure to water and debris; care should be taken not to drive through deep water. WATER INGESTION IS THE DRIVERS RESPONSIBILITY! The air filter is reusable and should be cleaned periodically.

FILTER IDENTIFICATION

720-473 Airaid Oiled Media
722-473 Airaid SynthaMax Dry Media - Black

721-473 Airaid SynthaMax Dry Media - Red
723-473 Airaid SynthaMax Dry Media - Blue

For your Oiled media filter we suggest using the AIRAID Filter Tune-Up Kit.

P/N 790-551 Aerosol Spray
P/N 790-550 Squeeze Spray

INTAKE SYSTEMS FOR VEHICLES LISTED ARE 50 STATE LEGAL. SEE AIRAID.COM FOR CARB STATUS ON EACH PART FOR A SPECIFIC VEHICLE.

Synthamax Dry Filters **do not** require oil. Service air filter as needed by cleaning with common non-petroleum all-purpose household cleaner and water. Simple Green®, Formula 409® or equivalent works great. Apply cleaner to outside of air filter and allow to soak. Then flush filter clean from the inside out with a garden hose and repeat steps if necessary. Do not apply high pressure water or air to clean filter. Allow filter to air dry and reinstall.